

NOTICE!!

These documents have been scanned!

Do not place un-scanned documents beneath this notice!

Do not remove this notice from this file!

GPO Jacket No. 560-102
Print Order 61540
Rise Business Services, LLC
Job=AZ15 5/16/2019



Box Number= AZ15059



Claim Begin-End: AMC406767-AMC406769

1 Initial Receipt



AZ15059-9

AMC406356-AMC407176

United States Department of the Interior
Bureau of Land Management
 LANDS/RECREATION & PLANNING
 ONE N CENTRAL AVE
 PHOENIX, AZ 85004 -2203
 Phone:

Receipt

No:

2316496

Transaction #: 2389915	ENTERED INTO COMPUTER	MAR 31 2011 <i>cm</i>
Date of Transaction: 03/28/2011		
CUSTOMER:		
MERRILL PALMER 128 SUNRAY DR LAKE HAVASU CITY, AZ 86403-5814 US		

LINE #	QTY	DESCRIPTION	REMARKS	UNIT PRICE	TOTAL
1	3.00	LOCATABLE MINERALS / MINING CLAIMS-NEW, UNADJUD, ONE OR MORE AUTH NOS / NEW MINING CLAIM LOCATION FEE \$34 CASES: AMC406767/\$34.00, AMC406768/\$34.00, AMC406769/\$34.00		- n/a -	102.00
2	3.00	LOCATABLE MINERALS / MINING CLAIMS-NEW, UNADJUD, ONE OR MORE AUTH NOS / NEW MINING CLAIM MAINT FEE \$140 CASES: AMC406767/\$140.00, AMC406768/\$140.00, AMC406769/\$140.00		- n/a -	420.00
3	3.00	LOCATABLE MINERALS / MINING CLAIMS-NEW, UNADJUD, ONE OR MORE AUTH NOS / NEW MINING CLAIM PROCESSING FEE \$15 CASES: AMC406767/\$15.00, AMC406768/\$15.00, AMC406769/\$15.00		- n/a -	45.00
TOTAL:					\$567.00

PAYMENT INFORMATION			
1	AMOUNT:	567.00	POSTMARKED: 03/22/2011
	TYPE:	CHECK	RECEIVED: 03/24/2011
	CHECK NO:	002642	
	NAME:	PALMER, MERRILL BOX 119 OXBOW OR 97840 US	

REMARKS

This receipt was generated by the automated BLM Collections and Billing System and is a paper representation of a portion of the official electronic record contained therein.

NOTICE!!

These documents have been scanned!

Do not place un-scanned documents beneath this notice!

Do not remove this notice from this file!

GPO Jacket No. 560-102
Print Order 61540
Rise Business Services, LLC
Job=AZ15 5/16/2019



Box Number= AZ15059



Claim Begin-End: AMC406767-AMC406769

2 Correspondence



AZ15059-9

AMC406356-AMC407176

**NO
DOCUMENTS
FOUND**

NO DOCUMENTS FOUND
NO DOCUMENTS FOUND

NOTICE!!

These documents have been scanned!

Do not place un-scanned documents beneath this notice!

Do not remove this notice from this file!

GPO Jacket No. 560-102
Print Order 61540
Rise Business Services, LLC
Job=AZ15 5/16/2019



Box Number= AZ15059



Claim Begin-End: AMC406767-AMC406769

3 Transfers

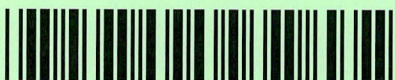

AZ15059-9

AMC406356-AMC407176

**NO
DOCUMENTS
FOUND**

NO DOCUMENTS FOUND
NO DOCUMENTS FOUND

NOTICE!!

These documents have been scanned!

Do not place un-scanned documents beneath this notice!

Do not remove this notice from this file!

GPO Jacket No. 560-102
Print Order 61540
Rise Business Services, LLC
Job=AZ15 5/16/2019



Box Number= AZ15059



Claim Begin-End: AMC406767-AMC406769

4 Miscellaneous



AZ15059-9

AMC406356-AMC407176

Dear People

Please find enclosed my check
for \$ 567.⁰⁰ dollars to file and record
with the U.S. BLM my three lode
mining claims Bouse 9, 10, 11.

Would you please send me a copy
of the recorded claims with the AMC
numbers to: Merrill Palmer

128 SUNRAY DR.

LAKE HAVASU CITY, AZ.

86403

Thank you!

Merrill Palmer

RECEIVED
BLM AZ STATE OFFICE
2011 MAR 24 A 9:39
PHOENIX, ARIZONA

NOTICE!!

These documents have been scanned!

Do not place un-scanned documents beneath this notice!

Do not remove this notice from this file!

GPO Jacket No. 560-102
Print Order 61540
Rise Business Services, LLC
Job=AZ15 5/16/2019



Box Number= AZ15059



Claim Begin-End: AMC406767-AMC406769

5 Annual Filings



AZ15059-9

AMC406356-AMC407176

406366

406767

406787

406869

407176

412220

440236

447899

When Recorded, Return to:

Newmont USA Limited
Attn: Land Department
1655 Mountain City Highway
Elko, NV 89801

AFFIDAVIT OF PAYMENT OF CLAIM MAINTENANCE FEE
AND NOTICE OF INTENT
TO HOLD MINING CLAIMS AND SITES

State of Nevada)
) ss.
County of Elko)

Brian G. Iverson, being duly sworn, deposes and states that: I am a citizen of the United States and at least eighteen years of age. I reside at 1655 Mountain City Highway, Elko, Nevada 89801. I am the duly authorized agent of **Newmont North America Exploration Limited, a Delaware corporation** ("Newmont"), the principle address of which is 1655 Mountain City Highway, Elko, Nevada 89801. I am personally acquainted with the mining claims and/or mill sites described in Exhibit A attached hereto, situated in the Plomosa mining district, La Paz County, Arizona (the "Claims"). The owner(s) of the Claim(s) is/are **Merrill Palmer**, whose address is **P.O. Box 119, Oxbow, OR, 97840**. The location notice for each of the Claims is recorded in the office of the county recorder of that county as described in Exhibit A hereto. To the extent known, the section, township and range in which the notice of location for each of the Claims was posted is described in Exhibit A hereto.

A claim maintenance fee of \$155.00 was timely paid by or at the expense of Newmont, lessee of the Claims, for each Claim instead of recording an affidavit of assessment work for the purpose of complying with the laws of the United States and holding the claims through the assessment year ending September 1, 2019. The required maintenance fee was also timely paid for each of the Claims for the assessment year ending September 1, 2018 to the extent required by the laws of the United States to maintain the Claims.

It is Newmont's intention to hold and maintain each of the Claims since the date of its location as provided by law.

ARIZONA - BOUSE 2018/2019 FILING

NO. OF CLAIMS 66
AMOUNT \$10230.
RECEIPT NO. 219331
INIT. LB

** BLM-ASO**

03:11 PM JUL 26 2018

ENTERED
JUL 26 2018
BY: RAM

This affidavit is made as of the date set forth below pursuant to Arizona Revised Statute §27-208.

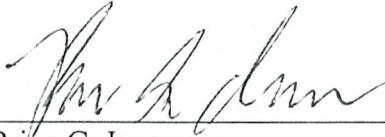

Brian G. Iverson
Manager of Land, U.S.

The foregoing instrument was acknowledged before me the 12th day of July, 2018 by Brian G. Iverson of **Newmont North America Exploration Limited, a Delaware corporation**, on behalf of the corporation.

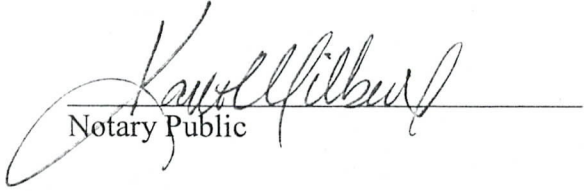

Notary Public

 KARLA WILBUR
NOTARY PUBLIC
STATE OF NEVADA
My Commission Expires: 8-26-2019
Certificate No: 15-2860-13

2018 JUL 25 PM 4:20

Exhibit A
Project: Arizona – Bouse

The following unpatented and patented mining claims located in:
T. 7 N., R. 17 W., GILA AND SALT RIVER MERIDIAN
T. 7 N., R. 18 W., GILA AND SALT RIVER MERIDIAN
LA PAZ COUNTY, ARIZONA

Arizona Mining Claim	Lead Serial No.	Type	Claim Name	Claimant Name	Loc Date
AMC406366 7	AMC406366	LODE	BOUSE #1	PALMER MERRILL	12/16/2010
AMC406367	AMC406366	LODE	BOUSE #2	PALMER MERRILL	12/16/2010
AMC406368	AMC406366	LODE	BOUSE #3	PALMER MERRILL	12/16/2010
AMC406369	AMC406366	LODE	BOUSE #4	PALMER MERRILL	12/16/2010
AMC406370	AMC406366	LODE	BOUSE #5	PALMER MERRILL	12/16/2010
AMC406371	AMC406366	LODE	BOUSE #6	PALMER MERRILL	12/16/2010
AMC406372	AMC406366	LODE	BOUSE #7	PALMER MERRILL	12/16/2010
AMC406373 J	AMC406366	LODE	BOUSE #8	PALMER MERRILL	12/16/2010
AMC406767 7	AMC406767	LODE	BOUSE #9	PALMER MERRILL	01/02/2011
AMC406768	AMC406767	LODE	BOUSE #10	PALMER MERRILL	01/02/2011
AMC406769 J	AMC406767	LODE	BOUSE #11	PALMER MERRILL	01/02/2011
AMC406787 7	AMC406787	LODE	BOUSE 12	PALMER MERRILL	01/05/2011
AMC406788	AMC406787	LODE	BOUSE 13	PALMER MERRILL	01/05/2011
AMC406789	AMC406787	LODE	BOUSE 14	PALMER MERRILL	01/05/2011
AMC406790	AMC406787	LODE	BOUSE 15	PALMER MERRILL	01/05/2011
AMC406791	AMC406787	LODE	BOUSE 16	PALMER MERRILL	01/05/2011
AMC406792	AMC406787	LODE	BOUSE 17	PALMER MERRILL	01/03/2011
AMC406793 J	AMC406787	LODE	BOUSE 18	PALMER MERRILL	01/03/2011
AMC406869 7	AMC406869	LODE	BOUSE #35	PALMER MERRILL	01/10/2011
AMC406870	AMC406869	LODE	BOUSE #34	PALMER MERRILL	01/10/2011
AMC406871	AMC406869	LODE	BOUSE #33	PALMER MERRILL	01/10/2011
AMC406872	AMC406869	LODE	BOUSE #32	PALMER MERRILL	01/10/2011
AMC406873	AMC406869	LODE	BOUSE #31	PALMER MERRILL	01/10/2011
AMC406874 J	AMC406869	LODE	BOUSE #30	PALMER MERRILL	01/10/2011
AMC407176 7	AMC407176	LODE	BOUSE #36	PALMER MERRILL	02/03/2011
AMC407177	AMC407176	LODE	BOUSE #37	PALMER MERRILL	02/03/2011
AMC407178	AMC407176	LODE	BOUSE #38	PALMER MERRILL	02/03/2011
AMC407179 J	AMC407176	LODE	BOUSE #39	PALMER MERRILL	02/03/2011

2018 JUN 25 P 1:19

Arizona Mining Claim	Lead Serial No.	Type	Claim Name	Claimant Name	Loc Date
AMC407180 7	AMC407176	LODE	BOUSE #40	PALMER MERRILL	02/03/2011
AMC407181	AMC407176	LODE	BOUSE #41	PALMER MERRILL	02/03/2011
AMC407182 J	AMC407176	LODE	BOUSE #42	PALMER MERRILL	02/03/2011
AMC412220 7	AMC412220	LODE	B 50	PALMER MERRILL	09/02/2011
AMC412221	AMC412220	LODE	B 51	PALMER MERRILL	09/02/2011
AMC412222	AMC412220	LODE	B 52	PALMER MERRILL	09/02/2011
AMC412223	AMC412220	LODE	B 53	PALMER MERRILL	09/02/2011
AMC412224	AMC412220	LODE	B 54	PALMER MERRILL	09/02/2011
AMC412225	AMC412220	LODE	B 55	PALMER MERRILL	09/02/2011
AMC412226	AMC412220	LODE	B 56	PALMER MERRILL	09/02/2011
AMC412227	AMC412220	LODE	B 57	PALMER MERRILL	09/02/2011
AMC412228	AMC412220	LODE	B 58	PALMER MERRILL	09/02/2011
AMC412229	AMC412220	LODE	B 59	PALMER MERRILL	09/02/2011
AMC412230	AMC412220	LODE	B 60	PALMER MERRILL	09/02/2011
AMC412231	AMC412220	LODE	B 61	PALMER MERRILL	09/02/2011
AMC412232	AMC412220	LODE	B 62	PALMER MERRILL	09/02/2011
AMC412233	AMC412220	LODE	B 63	PALMER MERRILL	09/02/2011
AMC412234	AMC412220	LODE	B 64	PALMER MERRILL	09/02/2011
AMC412235 J	AMC412220	LODE	B 65	PALMER MERRILL	09/02/2011
AMC440236 7	AMC440236	LODE	BOUSE 70	PALMER MERRILL	09/04/2016
AMC440237	AMC440236	LODE	BOUSE 71	PALMER MERRILL	09/04/2016
AMC440238	AMC440236	LODE	BOUSE 72	PALMER MERRILL	09/04/2016
AMC440239	AMC440236	LODE	BOUSE 73	PALMER MERRILL	09/04/2016
AMC440240	AMC440236	LODE	BOUSE 74	PALMER MERRILL	09/04/2016
AMC440241 J	AMC440236	LODE	BOUSE 75	PALMER MERRILL	09/04/2016
AMC447899 7	AMC447899	LODE	B 76	PALMER MERRILL	09/01/2017
AMC447900	AMC447899	LODE	B 77	PALMER MERRILL	09/01/2017
AMC447901	AMC447899	LODE	B 78	PALMER MERRILL	09/01/2017
AMC447902	AMC447899	LODE	B 79	PALMER MERRILL	09/01/2017
AMC447903	AMC447899	LODE	B 80	PALMER MERRILL	09/01/2017
AMC447904	AMC447899	LODE	B 81	PALMER MERRILL	09/01/2017
AMC447905	AMC447899	LODE	B 82	PALMER MERRILL	09/01/2017
AMC447906	AMC447899	LODE	B 19	PALMER MERRILL	09/01/2017
AMC447907	AMC447899	LODE	B 20	PALMER MERRILL	09/01/2017
AMC447908	AMC447899	LODE	B 21	PALMER MERRILL	09/01/2017
AMC447909 J	AMC447899	LODE	B 22	PALMER MERRILL	09/01/2017

PHOENIX, ARIZONA
 2019 JUL 25 P 1:19

Arizona Mining Claim	Lead Serial No.	Type	Claim Name	Claimant Name	Loc Date
AMC447910	AMC447899	LODE	B 23	PALMER MERRILL	09/01/2017
AMC447911	AMC447899	LODE	B 24	PALMER MERRILL	09/01/2017

2010 JUL 25 P 1:19
 PHOENIX, ARIZONA

United States Department of the Interior
Bureau of Land Management
 DIV OF LANDS, MINRLS & ENERGY
 ONE N CENTRAL AVE
 PHOENIX, AZ 85004 -4427
 Phone: 602-417-9200

Receipt

No: 4219331

Transaction #: 4334513	
Date of Transaction: 07/25/2018	
CUSTOMER:	
NEWMONT NORTH AMERICA EXPL LTD 1655 MOUNTAIN CITY HWY ELKO,NV 89801-2800 US	

LINE #	QTY	DESCRIPTION	REMARKS	UNIT PRICE	TOTAL
1	1.00	LOCATABLE MINERALS / MINING CLAIMS- NOT NEW-UNADJUD,ONE AUTH NO. ONLY / MINING CLAIM MONEY RECEIVED CASES: AMC406366/\$10230.00	2019 MAINT (66)	- n/a -	10230.00
TOTAL:					\$10,230.00

PAYMENT INFORMATION					
1	AMOUNT:	10230.00	POSTMARKED:	N/A	
	TYPE:	CHECK	RECEIVED:	07/25/2018	
	CHECK NO:	2000036606			
	NAME:	NEWMONT NORTH AMERICA EXPL LTD 1655 MOUNTAIN CITY HWY ELKO NV 89801-2800 US			

REMARKS

This receipt was generated by the automated BLM Collections and Billing System and is a paper representation of a portion of the official electronic record contained therein.

Dear People

Inclosed please find my check # 2050
in the amount of \$ 8,215⁰⁰ for the
maintenance fees for 53 lode mining
claims located in the county of La Paz,
Arizona and more fully described by
an attached 3 page list.

Please return a receipt to me at
Merrill Palmer

Po Box 119

Oxbow, OR. 97840

Phone 541 785 3543

Thank you very much!
Merrill Palmer

406366

406767

406787

406869

407176

412220

440236

2017 AUG -11 PM 3:05

ENTERED
AUG 08 2017
BY: RAM

BOUSE CLAIMS AMC. NUMBER

CLAIM NAME	AMC. NUMBER	SECTION	TOWNSHIP	RANGE
BOUSE #1	AMC406366 7	18	T7N	R17W
BOUSE #2	AMC406367	18	T7N	R17W
BOUSE #3	AMC406368	18	T7N	R17W
BOUSE #4	AMC406369	18	T7N	R17W
BOUSE #5	AMC406370	18	T7N	R17W
BOUSE #6	AMC406371	18	T7N	R17W
BOUSE #7	AMC406372	18	T7N	R17W
BOUSE #8	AMC406373 }	18	T7N	R17W
BOUSE #9	AMC406767 7	17-18	T7N	R17W
BOUSE #10	AMC406768	17	T7N	R17W
BOUSE #11	AMC406769 }	17	T7N	R17W
BOUSE #12	AMC406787 7	17	T7N	R17W
BOUSE #13	AMC406788	17	T7N	R17W
BOUSE #14	AMC406789	17	T7N	R17W
BOUSE #15	AMC406790	18	T7N	R17W
BOUSE #16	AMC406791	18	T7N	R17W
BOUSE #17	AMC406792	18	T7N	R17W
BOUSE # 18	AMC406793 }	18	T7N	R17W
BOUSE #30	AMC406874 7	13	T7N	R18W
BOUSE #31	AMC406873	13	T7N	R18W
BOUSE #32	AMC406872	13	T7N	R18W
BOUSE #33	AMC406871 }	13	T7N	R18W

393387

2011 AUG - 4 PM

CLAIM NAME	AMC NUMBER	SECTION	TOWNSHIP	RANGE
BOUSE #34	AMC406870	13	T7N	R18W
BOUSE #35	AMC406869	13	T7N	R18W
BOUSE #36	AMC407176	24	T7N	R18W
BOUSE #37	AMC407177	24	T7N	R18W
BOUSE #38	AMC407178	24	T7N	R18W
BOUSE #39	AMC407179	24	T7N	R18W
BOUSE #40	AMC407180	24	T7N	R18W
BOUSE #41	AMC407181	24-19	T7N	R18W-R17W
BOUSE #42	AMC407182	24-19	T7N	R18W-R17W

6 New Claims 2016

AMC440236	14 0070N 0180W 013 SE	BOUSE 70
AMC440237	14 0070N 0180W 013 SE	BOUSE 71
AMC440238	14 0070N 0170W 018 SW	BOUSE 72
AMC440239	14 0070N 0170W 018 SW	BOUSE 73
AMC440240	14 0070N 0170W 018 SW	BOUSE 74
AMC440241	14 0070N 0170W 018 SW	BOUSE 75

PALMER MERRILL
PALMER MERRILL
PALMER MERRILL
PALMER MERRILL
PALMER MERRILL
PALMER MERRILL

AMC440236	LODE	ACTIVE	09/04/2016	2017
AMC440236	LODE	ACTIVE	09/04/2016	2017
AMC440236	LODE	ACTIVE	09/04/2016	2017
AMC440236	LODE	ACTIVE	09/04/2016	2017
AMC440236	LODE	ACTIVE	09/04/2016	2017
AMC440236	LODE	ACTIVE	09/04/2016	2017

Page 2 of 3

2017 JUN 11 10:05

Total Claims This Page 15

EXHIBIT A

The "PROPERTY" consists of those certain unpatented lode mining claims situated in Sections 13 and 24, Township 7 North, Range 18 West, and Sections 7, 8, 17, 18 and 19, Township 7 North, Range 17 West, G&SR Mer., in the Bouse (Plomosa) Mining District, La Paz County, Arizona, the names of which and the place of record of the location notices thereof in the official records of the county recorder and the authorized office of the Bureau of Land Management are as follows:

<u>Name of Claim</u>	<u>County Records Instrument Number</u>	<u>BLM Serial # AMC</u>
B-50	2011-04526	412220 7
B-51	2011-04525	412221
B-52	2011-04524	412222
B-53	2011-04523	412223
B-54	2011-04522	412224
B-55	2011-04521	412225
B-56	2011-04520	412226
B-57	2011-04519	412227
B-58	2011-04518	412228
B-59	2011-04517	412229
B-60	2011-04516	412230
B-61	2011-04515	412231
B-62	2011-04514	412232
B-63	2011-04513	412233
B-64	2011-04512	412234
B-65	2011-04511	412235 J

Page 3 of 3

Total Claims This page 16

Grand Total all Three pages = 53

2011 APR 11 10:30 AM



Mer
PO E
Oxbo

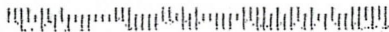

02 1P
0004726851 AUG 01 2017
MAILED FROM ZIP CODE 97840

RECEIVED

2017 AUG -4 P 3:05

PHOENIX, ARIZONA

To: U.S. Dept. of Interior
Bureau of Land Management
Arizona State office
One North Central Avenue Suite 800
Phoenix, Az. 85004-4487



UNITED STATES POSTAL SERVICE

Visit us at usps.com



Label 107R, January 2008



USPS TRACKING #

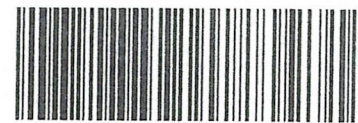

9114 9999 4431 4908 0773 45

LAB400R Aug 2013
7680-17-000-0669

United States Department of the Interior
Bureau of Land Management
 DIV OF LANDS, MINRLS & ENERGY
 ONE N CENTRAL AVE
 PHOENIX, AZ 85004 -4427
 Phone: 602-417-9200

Receipt

No: 3923879

Transaction #: 4033398	
Date of Transaction: 08/07/2017	
CUSTOMER:	
MERRILL I PALMER PO BOX 119 OXBOW,OR 97840-0119 US	

LINE #	QTY	DESCRIPTION	REMARKS	UNIT PRICE	TOTAL
1	1.00	LOCATABLE MINERALS / MINING CLAIMS- NOT NEW-UNADJUD,ONE AUTH NO. ONLY / MINING CLAIM MONEY RECEIVED CASES: AMC406366/\$8215.00	MAINT 2018/53	- n/a -	8215.00
TOTAL:					\$8,215.00

PAYMENT INFORMATION					
1	AMOUNT:	8215.00	POSTMARKED:	08/01/2017	
	TYPE:	CHECK	RECEIVED:	08/04/2017	
	CHECK NO:	2050			
	NAME:	PALMER, MERRILL I PO BOX 119 OXBOW OR 97840-0119 US			

REMARKS

This receipt was generated by the automated BLM Collections and Billing System and is a paper representation of a portion of the official electronic record contained therein.

406366

406767

412220

APPENDIX I

BOUSE CLAIMS AMC. NUMBER

PHOENIX, ARIZONA

2016 AUG -5 P 3:11

RECEIVED
BLM AZ STATE OFFICE

406787

406869

407176

CLAIM NAME	AMC. NUMBER	SECTION	TOWNSHIP	RANGE
1x BOUSE #1	AMC406366	18	T7N	R17W
2x BOUSE #2	AMC406367	18	T7N	R17W
3x BOUSE #3	AMC406368	18	T7N	R17W
4x BOUSE #4	AMC406369	18	T7N	R17W
5x BOUSE #5	AMC406370	18	T7N	R17W
6x BOUSE #6	AMC406371	18	T7N	R17W
7x BOUSE #7	AMC406372	18	T7N	R17W
8x BOUSE #8	AMC406373	18	T7N	R17W
9x BOUSE #9	AMC406767	17-18	T7N	R17W
10x BOUSE #10	AMC406768	17	T7N	R17W
11x BOUSE #11	AMC406769	17	T7N	R17W
12x BOUSE #12	AMC406787	17	T7N	R17W
13x BOUSE #13	AMC406788	17	T7N	R17W
14x BOUSE #14	AMC406789	17	T7N	R17W
15x BOUSE #15	AMC406790	18	T7N	R17W
16x BOUSE #16	AMC406791	18	T7N	R17W
17x BOUSE #17	AMC406792	18	T7N	R17W
18x BOUSE #18	AMC406793	18	T7N	R17W
19x BOUSE #30	AMC406874	13	T7N	R18W
20x BOUSE #31	AMC406873	13	T7N	R18W
21x BOUSE #32	AMC406872	13	T7N	R18W

ENTERED
AUG 09 2016
BY: R Am

RECEIPT # 3623211

APPENDIX I continued:

<u>CLAIM NAME</u>	<u>AMC NUMBER</u>	<u>SECTION</u>	<u>TOWNSHIP</u>	<u>RANGE</u>
22 x BOUSE #33	AMC406871	13	T7N	R18W
23 x BOUSE #34	AMC406870	13	T7N	R18W
24 x BOUSE #35	AMC406869	13	T7N	R18W
25 x BOUSE #36	AMC407176	24	T7N	R18W
26 x BOUSE #37	AMC407177	24	T7N	R18W
27 x BOUSE #38	AMC407178	24	T7N	R18W
28 x BOUSE #39	AMC407179	24	T7N	R18W
29 x BOUSE #40	AMC407180	24	T7N	R18W
30 x BOUSE #41	AMC407181	24-19	T7N	R18W-R17W
31 x BOUSE #42	AMC407182	24-19	T7N	R18W-R17W

PHOENIX, ARIZONA

2010 AUG -5 P 3 11

RECEIVED
BLM AZ STATE OFFICE

EXHIBIT A

The "PROPERTY" consists of those certain unpatented lode mining claims situated in Sections 13 and 24, Township 7 North, Range 18 West, and Sections 7, 8, 17, 18 and 19, Township 7 North, Range 17 West, G&SR Mer., in the Bouse (Plomosa) Mining District, La Paz County, Arizona, the names of which and the place of record of the location notices thereof in the official records of the county recorder and the authorized office of the Bureau of Land Management are as follows:

<u>Name of Claim</u>	<u>County Records Instrument Number</u>	<u>BLM Serial # AMC</u>
32 YB-50	2011-04526	412220 7
33 YB-51	2011-04525	412221
34 YB-52	2011-04524	412222
35 YB-53	2011-04523	412223
36 YB-54	2011-04522	412224
37 YB-55	2011-04521	412225
38 YB-56	2011-04520	412226
39 X B-57	2011-04519	412227
40 X B-58	2011-04518	412228
41 X B-59	2011-04517	412229
42 X B-60	2011-04516	412230
43 X B-61	2011-04515	412231
44 Y B-62	2011-04514	412232
45 X B-63	2011-04513	412233
46 X B-64	2011-04512	412234
47 X B-65	2011-04511	412235 }

PHOENIX, ARIZONA

2016 AUG -5 P 3 12

RECEIVED
BLM AZ STATE OFFICE

PRESS FIRMLY TO SEAL

PRIORITY® ★ MAIL ★

- DATE OF DELIVERY SPECIFIED*
- USPS TRACKING™ INCLUDED*
- INSURANCE INCLUDED*
- PICKUP AVAILABLE

* Domestic only

WHEN USED INTERNATIONALLY,
A CUSTOMS DECLARATION
LABEL MAY BE REQUIRED.

RECEIVED
BLM AZ STATE OFFICE
2016 AUG -5 P 3 11
PHOENIX, ARIZONA



This packaging is the property of the U.S. Postal Service® and is provided solely for use in sending Priority Mail® shipments. Misuse may be a violation of federal law. This packaging is not for resale. EPI4 © U.S. Postal Service, July 2013. All rights reserved.

FROM:

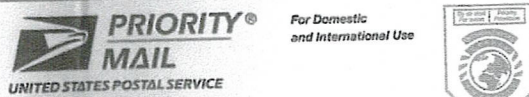

From M. PALMER
PO BOX 1192
OXFORD
95840

TO
US DEPT. OF INTERIOR
BUREAU OF LAND MANAGEMENT
ARIZONA STATE OFFICE
OWEN CENTRAL AVE
PHOENIX AZ Suite 500
85004-4427

Label 228, January 2008



USPS TRACKING #



9114 9999 4431 4888 0818 37

LAB400R Aug. 2013
7890-17-000-0689

July 2013
625 x 15.125

VISIT US AT USPS.COM®
ORDER FREE SUPPLIES ONLINE



DuPont™ Tyvek®
Protect What's Inside.™

TYVEK® IS RECYCLABLE.
HDPE ©2003 DU PONT™ AND TYVEK® ARE TRADEMARKS OF DUPONT.

PRESS FIRMLY TO SEAL

Merrill Palmer
P.O. Box 119
Oxbow, Oregon
97840

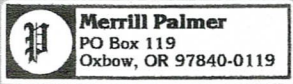

RECEIVED
BLM AZ STATE OFFICE

2016 AUG -5 P 3 11

PHOENIX, ARIZONA

To U S Dept of Interior
Bureau of Land Management
Arizona State Office
ONE North Central Ave. Suite 800
Phoenix, Arizona 85004-4427

attest maintenance fee recording!

United States Department of the Interior
Bureau of Land Management
 DIV OF LANDS, MINRLS & ENERGY
 ONE N CENTRAL AVE
 PHOENIX, AZ 85004 -4427
 Phone: 602-417-9200

Receipt

No: 3623211

Transaction #: 3726941	
Date of Transaction: 08/08/2016	
CUSTOMER:	
MERRILL I PALMER PO BOX 119 OXBOW, OR 97840-0119 US	

LINE #	QTY	DESCRIPTION	REMARKS	UNIT PRICE	TOTAL
1	1.00	LOCATABLE MINERALS / MINING CLAIMS- NOT NEW-UNADJUD, ONE AUTH NO. ONLY / MINING CLAIM MONEY RECEIVED CASES: AMC406366/\$7285.00	MAINT FEE 2017 - 47	- n/a -	7285.00
TOTAL:					\$7,285.00

PAYMENT INFORMATION			
1	AMOUNT:	7285.00	POSTMARKED: N/A
	TYPE:	CHECK	RECEIVED: 08/05/2016
	CHECK NO:	1724	
	NAME:	PALMER, MERRILL I PO BOX 119 OXBOW OR 97840-0119 US	

REMARKS

This receipt was generated by the automated BLM Collections and Billing System and is a paper representation of a portion of the official electronic record contained therein.

406787 412220
406869 406306
407176 406767

Dear People

Please find my check for \$7285⁰⁰ dollars in payment for 47 lode mining claims maintenance fees of 155⁰⁰ per claim.

I have attached two different claims lists one list titled "Bouse Claims AMC numbers" has 31 lode claims listed that are currently in my name of Merrill Palmer Locator.

The other list of 16 lode claims is titled "Exhibit A" B50 through B65 I have recently purchased from AVEN ASSOCIATES LLC.

My understanding is AVEN is currently recording this transaction with the La Paz County AZ and then will record the same quit claim deed with your BLM office. I have enclosed a copy for your files and wish to pay the maintenance fees on these 16 claims together with the 31 claims on the other list for a total of 47 lode claims.

If there is any problem my phone # is 541 785 3543. I am currently in Oregon.

Please make any receipts to:

Merrill Palmer
P.O. Box 119
Oxbow, OR. 97840

Thank you very much!
Merrill Palmer

ENTERED
AUG 18 2015
BY: RE

RECEIVED
BLM ARIZONA OFFICE
2015 AUG 10 P 3:30
PHOENIX, ARIZONA

EXHIBIT A

The "PROPERTY" consists of those certain unpatented lode mining claims situated in Sections 13 and 24, Township 7 North, Range 18 West, and Sections 7, 8, 17, 18 and 19, Township 7 North, Range 17 West, G&SR Mer., in the Bouse (Plomosa) Mining District, La Paz County, Arizona, the names of which and the place of record of the location notices thereof in the official records of the county recorder and the authorized office of the Bureau of Land Management are as follows:

<u>Name of Claim</u>	<u>County Records Instrument Number</u>	<u>BLM Serial # AMC</u>
B-50	2011-04526	412220
B-51	2011-04525	412221
B-52	2011-04524	412222
B-53	2011-04523	412223
B-54	2011-04522	412224
B-55	2011-04521	412225
B-56	2011-04520	412226
B-57	2011-04519	412227
B-58	2011-04518	412228
B-59	2011-04517	412229
B-60	2011-04516	412230
B-61	2011-04515	412231
B-62	2011-04514	412232
B-63	2011-04513	412233
B-64	2011-04512	412234
B-65	2011-04511	412235

RECEIVED
BLM AZ DISTRICT OFFICE
2015 AUG 10 P 3:31
PHOENIX, ARIZONA

RECEIPT # 3364288

FYI This Quitclaim Deed
All ready been filed or will soon
be filed by Aven Associates
in any event I want to pay
Maintenance fees for \$50 to
\$65 as on attached list.

QUITCLAIM DEED

AVEN Associates LLC, (AVEN), Suite #131, 7400 North Oracle Road, Tucson, Arizona 86704, the "Grantor," for and in consideration of Ten Dollars (\$10.00) and other valuable considerations, does hereby quitclaim to Merrill Palmer, P.O. Box 119, Oxbow, Oregon, 97840, the "Grantee," all of its right, title and interest in and to those certain unpatented lode mining claims (PROPERTY) of Grantor situated in the Bouse (Plomosa) Mining District, La Paz County, Arizona, the names of which and the place of record of the location notices thereof in the official records of said County and the Arizona State Office of the Bureau of Land Management are as set forth in Exhibit A attached hereto and incorporated herein by this reference.

DATED this 13th day of July, 2015.

Steven D. Van Nort

Steven D. Van Nort
Member: AVEN Associates LLC

State of Arizona)
County of Pima) ss.

Before me, on this 13th day of July, 2015, personally appeared before me, the undersigned notary public, Steven D. Van Nort, Member AVEN Associates LLC, and execute the foregoing document.

My commission expires:
January 11, 2016

Alison Lange
Notary Public

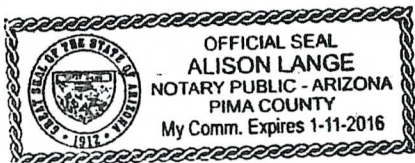

RECEIVED
BLM AZ REGIONAL OFFICE
2015 AUG 10 P 3:31
PHOENIX, ARIZONA

BOUSE CLAIMS AMC. NUMBER

CLAIM NAME	AMC. NUMBER	SECTION	TOWNSHIP	RANGE
BOUSE #1	AMC406366	18	T7N	R17W
BOUSE #2	AMC406367	18	T7N	R17W
BOUSE #3	AMC406368	18	T7N	R17W
BOUSE #4	AMC406369	18	T7N	R17W
BOUSE #5	AMC406370	18	T7N	R17W
BOUSE #6	AMC406371	18	T7N	R17W
BOUSE #7	AMC406372	18	T7N	R17W
BOUSE #8	AMC406373	18	T7N	R17W
BOUSE #9	AMC406767	17-18	T7N	R17W
BOUSE #10	AMC406768	17	T7N	R17W
BOUSE #11	AMC406769	17	T7N	R17W
BOUSE #12	AMC406787	17	T7N	R17W
BOUSE #13	AMC406788	17	T7N	R17W
BOUSE #14	AMC406789	17	T7N	R17W
BOUSE #15	AMC406790	18	T7N	R17W
BOUSE #16	AMC406791	18	T7N	R17W
BOUSE #17	AMC406792	18	T7N	R17W
BOUSE # 18	AMC406793	18	T7N	R17W
BOUSE #30	AMC406874	13	T7N	R18W
BOUSE #31	AMC406873	13	T7N	R18W
BOUSE #32	AMC406872	13	T7N	R18W
BOUSE #33	AMC406871	13	T7N	R18W

RECEIVED
BLM A7 OFFICE
2015 AUG 10 P 3:31
PHOENIX, ARIZONA

RECEIPT # 3364288

CLAIM NAME	AMC NUMBER	SECTION	TOWNSHIP	RANGE
BOUSE #34	AMC406870	13	T7N	R18W
BOUSE #35	AMC406869	13	T7N	R18W
BOUSE #36	AMC407176	24	T7N	R18W
BOUSE #37	AMC407177	24	T7N	R18W
BOUSE #38	AMC407178	24	T7N	R18W
BOUSE #39	AMC407179	24	T7N	R18W
BOUSE #40	AMC407180	24	T7N	R18W
BOUSE #41	AMC407181	24-19	T7N	R18W-R17W
BOUSE #42	AMC407182	24-19	T7N	R18W-R17W

RECEIVED
BLM AUSTIN OFFICE
2015 AUG 10 P 3:31
PHOENIX, ARIZONA

Merrill Palmer
P.O. Box 119
Oxbow, OR. 97840

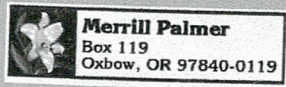

RECEIVED
BLM AZ STATE OFFICE

2015 AUG 10 P 3:31

PHOENIX, ARIZONA

MINING ACCOUNTS:

To U.S. Dept of Interior
ARIZONA STATE OFFICE
ONE NORTH CENTRAL AVENUE
SUITE 800
PHOENIX, AZ. 85004-4427



1000

85004

U.S. POSTAGE
PAID
BAKER
97811
AUG 05,
AMC
\$7
001160

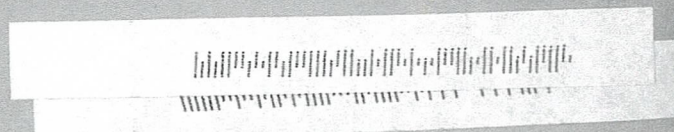

United States Department of the Interior
Bureau of Land Management
 LANDS/RECREATION & PLANNING
 ONE N CENTRAL AVE
 PHOENIX, AZ 85004 -2203
 Phone: 602-417-9200

Receipt

No: 3364288

Transaction #: 3462333	
Date of Transaction: 08/11/2015	
CUSTOMER:	
MERRILL I PALMER PO BOX 119 OXBOW, OR 97840-0119 US	

LINE #	QTY	DESCRIPTION	REMARKS	UNIT PRICE	TOTAL
1	1.00	LOCATABLE MINERALS / MINING CLAIMS-NOT NEW-UNADJUD, ONE AUTH NO. ONLY / MINING CLAIM MONEY RECEIVED CASES: AMC412220/\$7285.00	MAINT FEE PYMNT (47) 2016	- n/a -	7285.00
TOTAL:					\$7,285.00

PAYMENT INFORMATION			
1	AMOUNT:	7285.00	POSTMARKED: 08/05/2015
	TYPE:	CHECK	RECEIVED: 08/10/2015
	CHECK NO:	1077	
	NAME:	PALMER, MERRIL I PO BOX 119 OXBOW OR 97840-0119 US	

REMARKS

This receipt was generated by the automated BLM Collections and Billing System and is a paper representation of a portion of the official electronic record contained therein.

8/11/2015

AVEN Associates LLC

L. Clark Arnold
Alan F. Edwards
Frank J. Nelson
Steven D. Van Nort

7400 North Oracle Road
Suite 131
Tucson, Arizona 85704
520 797-1393
520 742-7280
aven@theriver.com

July 2, 2012

U.S. Department of the Interior
Bureau of Land Management
Arizona State Office
One North Central Ave. Suite 800
Phoenix, AZ 85004-4427

Re: Mining claim Maintenance Fees for Assessment Year Ending September 1, 2013

Ladies/Gentlemen,

Enclosed please find our check #2150 in the amount of \$6,580.00 to cover maintenance fees of \$140.00 each for the 47 claims described on the claim list (Exhibit A) attached hereto.

This letter is evidence of owner's intention to hold such claims through the assessment year ending on September 1, 2013.

Please return receipts and date stamped copies to me at the above address. If questions arise regarding this filing please get in touch using the information provided above.

Sincerely,

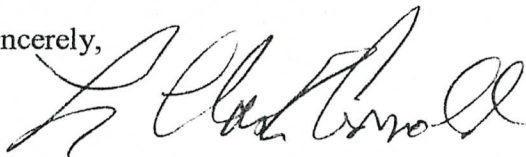

L. Clark Arnold
AVEN Associates LLC

ENTERED INTO COMPUTER

JUL 19 2012 PB

RECEIVED
BLM AZ STATE OFFICE
2012 JUL -6 P 1:47
PHOENIX, ARIZONA

Exhibit A

Claim	AMC Number	County	Claim	AMC Number	County
Bouse #1	AMC406366	La Paz	B-50	AMC412220	La Paz
Bouse #2	AMC406367	La Paz	B-51	AMC412221	La Paz
Bouse #3	AMC406368	La Paz	B-52	AMC412222	La Paz
Bouse #4	AMC406369	La Paz	B-53	AMC412223	La Paz
Bouse #5	AMC406370	La Paz	B-54	AMC412224	La Paz
Bouse #6	AMC406371	La Paz	B-55	AMC412225	La Paz
Bouse #7	AMC406372	La Paz	B-56	AMC412226	La Paz
Bouse #8	AMC406373	La Paz	B-57	AMC412227	La Paz
Bouse #9	AMC406767	La Paz	B-58	AMC412228	La Paz
Bouse #10	AMC406768	La Paz	B-59	AMC412229	La Paz
Bouse #11	AMC406769	La Paz	B-60	AMC412230	La Paz
Bouse #12	AMC406787	La Paz	B-61	AMC412231	La Paz
Bouse #13	AMC406788	La Paz	B-62	AMC412232	La Paz
Bouse #14	AMC406789	La Paz	B-63	AMC412233	La Paz
Bouse #15	AMC406790	La Paz	B-64	AMC412234	La Paz
Bouse #16	AMC406791	La Paz	B-65	AMC412235	La Paz
Bouse #17	AMC406792	La Paz			
Bouse #18	AMC406793	La Paz			
Bouse #30	AMC406874	La Paz			
Bouse #31	AMC406873	La Paz			
Bouse #32	AMC406872	La Paz			
Bouse #33	AMC406871	La Paz			
Bouse #34	AMC406870	La Paz			
Bouse #35	AMC406869	La Paz			
Bouse #36	AMC407176	La Paz			
Bouse #37	AMC407177	La Paz			
Bouse #38	AMC407178	La Paz			
Bouse #39	AMC407179	La Paz			
Bouse #40	AMC407180	La Paz			
Bouse #41	AMC407181	La Paz			
Bouse #42	AMC407182	La Paz			

ENTERED INTO COMPUTER
 JUL 19 2012 PB

NO. OF CLAIMS 47
 AMOUNT \$6580.00
 RECEIPT NO. 26045764
 INIT. DAI
 ** BLM-ASO**

RECEIVED
 BLM AZ STATE OFFICE

2012 JUL -6 P 1:47
 PHOENIX, ARIZONA

~~NO. OF
 AMOUNT
 RECEIPT NO.
 INIT.
 ** BLM-ASO**~~

AVEN Associates LLC
7400 N. Oracle Road, #131
Tucson, AZ 85704

TUCSON AZ 85704
03 JUN 2012 9:52 AM



US Bureau of Land Management
One North Central Ave
Suite 800
Phoenix, AZ 85004

RECEIVED
BLM AZ STATE OFFICE
2012 JUL -6 P 1:47
PHOENIX, ARIZONA

ATTN: MINING CLAIM ACQUIS. FEES 85004+4427



United States Department of the Interior
Bureau of Land Management
 LANDS/RECREATION & PLANNING
 ONE N CENTRAL AVE
 PHOENIX, AZ 85004 -2203
 Phone: 602-417-9200

Receipt

No: 2604564

Transaction #: 2684622
 Date of Transaction: 07/09/2012

ENTERED INTO COMPUTER

CUSTOMER: JUL 19 2012 PB

AVEN ASSOCIATES
 7400 N ORACLE RD #131
 TUCSON, AZ 85704 US

LINE #	QTY	DESCRIPTION	REMARKS	UNIT PRICE	TOTAL
1	1.00	LOCATABLE MINERALS / MINING CLAIMS-NOT NEW-UNADJUD, ONE AUTH NO. ONLY / MINING CLAIM MONEY RECEIVED CASES: AMC406366/\$6580.00	MAINT FEE PYMNT (47) 2013	- n/a -	6580.00
TOTAL:					\$6,580.00

PAYMENT INFORMATION

1	AMOUNT:	6580.00	POSTMARKED:	N/A
	TYPE:	CHECK	RECEIVED:	07/09/2012
	CHECK NO:	2150		
	NAME:	AVEN ASSOCIATES 7400 N ORACLE RD #131 TUCSON AZ 85704 US		

REMARKS

This receipt was generated by the automated BLM Collections and Billing System and is a paper representation of a portion of the official electronic record contained therein.

Lead File No.

AMC 406366 - 373	406366	} ALL LOBE CLAIMS 20.66 Acres each PB
406767 - 769	406767	
406787 - 793	406787	
406869 - 874	406869	
407176 - 182	407176	
412220 - 235	412220	

Message:

47 ROWS RETRIEVED

CBS Export Results Report

Include Resolved Records

Record Status

- Error Records (E/M/I)
- Accepted Records (A/W)
- "On Hold" Records (H)
- All Records (for s/n or receipt nr)
- Exported, No Results From CBS
- New (not yet exported)

Enter export Date (mm/dd/yyyy)

Serial Number match (optional)

Receipt Nr (optional)

Export Nr (exclusive)

LR2000 User (defaults to login)

Search Criteria

Responsible Area (Errors Only)

- User (U,X)
- Programmer (P,X)
- All (U,P,X)

[User Guide](#)

	Resend?	Export Nr	A/D	Serial Nr	Multi	Code	S Amount	Remarks	Receipt Nr	LR2000 User	#Msg	Resolved?	OK	Stat1	Area	CBS Msg 1	Stat2	Area	Msg 2	CBS 392 ID	392 S Amt	Action	Update Date	Resend	Resend Orig
1	<input type="checkbox"/>	3536618	A	AMC406366		682	140.00	2013	2604564	PAULINEB		<input type="checkbox"/>								1803878	6580.00	7/19/2012 12:27			
2	<input type="checkbox"/>	3536619	A	AMC406367		682	140.00	2013	2604564	PAULINEB		<input type="checkbox"/>								1803878	6580.00	7/19/2012 12:27			
3	<input type="checkbox"/>	3536620	A	AMC406368		682	140.00	2013	2604564	PAULINEB		<input type="checkbox"/>								1803878	6580.00	7/19/2012 12:27			
4	<input type="checkbox"/>	3536621	A	AMC406369		682	140.00	2013	2604564	PAULINEB		<input type="checkbox"/>								1803878	6580.00	7/19/2012 12:27			
5	<input type="checkbox"/>	3536622	A	AMC406370		682	140.00	2013	2604564	PAULINEB		<input type="checkbox"/>								1803878	6580.00	7/19/2012 12:27			
6	<input type="checkbox"/>	3536623	A	AMC406371		682	140.00	2013	2604564	PAULINEB		<input type="checkbox"/>								1803878	6580.00	7/19/2012 12:27			
7	<input type="checkbox"/>	3536624	A	AMC406372		682	140.00	2013	2604564	PAULINEB		<input type="checkbox"/>								1803878	6580.00	7/19/2012 12:27			
8	<input type="checkbox"/>	3536625	A	AMC406373		682	140.00	2013	2604564	PAULINEB		<input type="checkbox"/>								1803878	6580.00	7/19/2012 12:27			
9	<input type="checkbox"/>	3536626	A	AMC406767		682	140.00	2013	2604564	PAULINEB		<input type="checkbox"/>								1803878	6580.00	7/19/2012 12:28			
10	<input type="checkbox"/>	3536627	A	AMC406768		682	140.00	2013	2604564	PAULINEB		<input type="checkbox"/>								1803878	6580.00	7/19/2012 12:28			
11	<input type="checkbox"/>	3536628	A	AMC406769		682	140.00	2013	2604564	PAULINEB		<input type="checkbox"/>								1803878	6580.00	7/19/2012 12:28			
12	<input type="checkbox"/>	3536629	A	AMC406787		682	140.00	2013	2604564	PAULINEB		<input type="checkbox"/>								1803878	6580.00	7/19/2012 12:29			
13	<input type="checkbox"/>	3536630	A	AMC406788		682	140.00	2013	2604564	PAULINEB		<input type="checkbox"/>								1803878	6580.00	7/19/2012 12:29			
14	<input type="checkbox"/>	3536631	A	AMC406789		682	140.00	2013	2604564	PAULINEB		<input type="checkbox"/>								1803878	6580.00	7/19/2012 12:29			
15	<input type="checkbox"/>	3536632	A	AMC406790		682	140.00	2013	2604564	PAULINEB		<input type="checkbox"/>								1803878	6580.00	7/19/2012 12:29			
16	<input type="checkbox"/>	3536633	A	AMC406791		682	140.00	2013	2604564	PAULINEB		<input type="checkbox"/>								1803878	6580.00	7/19/2012 12:29			
17	<input type="checkbox"/>	3536634	A	AMC406792		682	140.00	2013	2604564	PAULINEB		<input type="checkbox"/>								1803878	6580.00	7/19/2012 12:29			
18	<input type="checkbox"/>	3536635	A	AMC406793		682	140.00	2013	2604564	PAULINEB		<input type="checkbox"/>								1803878	6580.00	7/19/2012 12:29			
19	<input type="checkbox"/>	3536636	A	AMC406869		682	140.00	2013	2604564	PAULINEB		<input type="checkbox"/>								1803878	6580.00	7/19/2012 12:30			
20	<input type="checkbox"/>	3536637	A	AMC406870		682	140.00	2013	2604564	PAULINEB		<input type="checkbox"/>								1803878	6580.00	7/19/2012 12:30			

Amc 409657
Amc 406366
Amc 406767
Amc 406787

AVEN Associates LLC

L. Clark Arnold
Alan F. Edwards
Frank J. Nelson
Steven D. Van Nort

7400 North Oracle Road
Suite 131
Tucson, Arizona 85704
520 797-1393
520 742-7280
aven@theriver.com

August 20, 2011

Amc 406869
Amc 407176

United States Department of the Interior
Bureau of Land Management
Arizona State Office
One North Central Avenue, Suite 800
Phoenix, AZ 85004-4427

RE: Mining Claim Maintenance Fees for Assessment Year Ending September 1, 2012.

Dear Sir or Madam,

Enclosed is a check in the amount of \$5040.00, which serves as payment of the Maintenance Fees of \$140.00 for each of the 36 unpatented claims described on the claim list (Exhibit A) attached hereto.

This letter is evidence of owner's intention to hold such claims through the assessment year ending on September 1, 2011.

<u>Claim Group</u>	<u>County</u>	<u>Number of Claims</u>
Peg Leg	Pinal	5
Bouse	La Paz	31
	Total Claims	36

Please return receipts and date stamped copies to me at the above address. If you have any questions concerning this filing please call me at the number listed above.

Sincerely,

L. Clark Arnold

NO. OF CLAIMS 36
AMOUNT 5040.00
RECEIPT NO. 2407034
INIT. SP
** BLM-ASO **

AUG 26 2011 Cm

RECEIVED
BLM AZ STATE OFFICE
2011 AUG 17 A 8:01
PHOENIX, ARIZONA

20-Aug-11

Exhibit A

Claim	MC Number	County
Peg Leg	PL-6	AMC409657 Pinal
	PL-7	AMC409658 Pinal
	PL-12	AMC409659 Pinal
	PL-27	AMC409660 Pinal
	PL-31	AMC409661 Pinal

51

Claim	MC Number	County
Bouse	Bouse #1	AMC406366 La Paz
	Bouse #2	AMC406367 La Paz
	Bouse #3	AMC406368 La Paz
	Bouse #4	AMC406369 La Paz
	Bouse #5	AMC406370 La Paz
	Bouse #6	AMC406371 La Paz
	Bouse #7	AMC406372 La Paz
	Bouse #8	AMC406373 La Paz
	Bouse #9	AMC406767 La Paz
	Bouse #10	AMC406768 La Paz
	Bouse #11	AMC406769 La Paz
	Bouse #12	AMC406787 La Paz
	Bouse #13	AMC406788 La Paz
	Bouse #14	AMC406789 La Paz
	Bouse #15	AMC406790 La Paz
	Bouse #16	AMC406791 La Paz
	Bouse #17	AMC406792 La Paz
	Bouse #18	AMC406793 La Paz
	Bouse #30	AMC406874 La Paz
	Bouse #31	AMC406873 La Paz
	Bouse #32	AMC406872 La Paz
	Bouse #33	AMC406871 La Paz
	Bouse #34	AMC406870 La Paz
	Bouse #35	AMC406869 La Paz
	Bouse #36	AMC407176 La Paz
	Bouse #37	AMC407177 La Paz
	Bouse #38	AMC407178 La Paz
	Bouse #39	AMC407179 La Paz
	Bouse #40	AMC407180 La Paz
	Bouse #41	AMC407181 La Paz
	Bouse #42	AMC407182 La Paz

31

PHOENIX, ARIZONA

2011 AUG 17 A 8:07

RECEIVED
BLM AZ STATE OFFICE

AVEN Associates LLC
7400 N. Oracle Rd #131
Tucson, AZ 85704

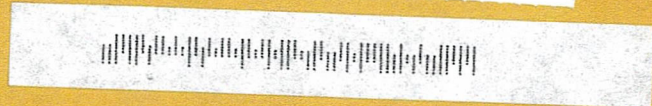

RETURN RECEIPT
REQUESTED

United States Department of the Interior
Bureau of Land Management
Arizona State Office
One North Central Avenue
Suite 800
Phoenix, AZ 85004-4427

RECEIVED
STATE OFFICE
2011 AUG 16 P 1:51
PHOENIX, ARIZONA

United States Department of the Interior
Bureau of Land Management
 LANDS/RECREATION & PLANNING
 ONE N CENTRAL AVE
 PHOENIX, AZ 85004 -2203
 Phone: 602-417-9200

Receipt

No: 2407034

Transaction #: 2482310	
Date of Transaction: 08/17/2011	
CUSTOMER:	
AVEN ASSOCIATES 7400 N ORACLE RD #131 TUCSON, AZ 85704 US	

LINE #	QTY	DESCRIPTION	REMARKS	UNIT PRICE	TOTAL
1	1.00	LOCATABLE MINERALS / MINING CLAIMS-NOT NEW-UNADJUD, ONE AUTH NO. ONLY / MINING CLAIM MONEY RECEIVED CASES: AMC409657/\$5040.00	MAINT-36	- n/a -	5040.00
TOTAL:					\$5,040.00

PAYMENT INFORMATION					
1	AMOUNT:	5040.00	POSTMARKED:	08/15/2011	
	TYPE:	CHECK	RECEIVED:	08/17/2011	
	CHECK NO:	1871			
	NAME:	AVEN ASSOCIATES LLC 7400 N ORACLE RD #131 TUCSON AZ 85704 US			

REMARKS

This receipt was generated by the automated BLM Collections and Billing System and is a paper representation of a portion of the official electronic record contained therein.

NOTICE!!

These documents have been scanned!

Do not place un-scanned documents beneath this notice!

Do not remove this notice from this file!

GPO Jacket No. 560-102
Print Order 61540
Rise Business Services, LLC
Job=AZ15 5/16/2019



Box Number= AZ15059



Claim Begin-End: AMC406767-AMC406769

6 Location Notices-Amendments and Supporting Documents



AZ15059-9

AMC406356-AMC407176

MINING CLAIM STATUS REPORT

DATA ENTERED INTO COMPUTER

MAR 31 2011
cm

MTP Checked by _____
GEO Checked by _____

LEAD SERIAL NUMBER AMC 406767 thru AMC 406769

OF CLAIMS & TYPE

3 LODE
_____ PLACER
_____ ASSOCIATION PLACER
_____ MILL SITE
_____ TUNNEL SITE

CHARGES

Location Fee @ \$34 = \$ 102
Processing Fee @ \$15 = \$ 45
Maintenance Fee @ \$140 = \$ 420
Overage (+) \$ _____
Shortage (-) \$ _____
Other Fees \$ _____
TOTAL \$ 567

ARE THERE ENOUGH LOCATORS?

Yes () No () _____

DOCUMENTS RECEIVED VIA -

Over-the-Counter () Mail ()

TIMELY FILED?

Yes () No ()

LEGAL DESCRIPTION -

T 7W R 17W SEC 17,18
T _____ R _____ SEC _____
T _____ R _____ SEC _____
T _____ R _____ SEC _____

BLM () FOREST SERVICE () _____ SUBJ TO PL 359: Yes () No ()

WILDERNESS AREA: No () Yes () _____

SPLIT ESTATE - N/A () SX () PX () SRHA () OTHER () _____

Proper Notice Filed if Located on SHRA Lands? N/A () Yes () No ()

RECONVEYED MINERALS ON BLM LANDS REQUIRE OPENING ORDERS FROM 1944 TO 1993 -

Open to Entry on: _____ N/A ()

COMMENTS/STATUS - VOID () PARTIALLY VOID () PVT MINERALS () WITHDRAWN LANDS ()

OTHER () _____

Claimant acknowledges that portions of the following claims(s) site(s) may be void or voidable.

Printed Name of Claimant _____ Signature of Claimant _____

***** FINAL ADJUDICATION *****

DATE 7/11/2011 INITIALS TS ok

AMC 406767

Recorded at the Request of:

When recorded mail to:
Merrill Palmer
128 SUNRAY DR.
LAKE HAVASU CITY
86403

RECEIVED
BLM AZ STATE OFFICE
2011 MAR 24 A 9:39
PHOENIX, ARIZONA

NOTICE OF MINING CLAIM LOCATION

- Location Amendment *Check one only*
- Placer Lode Millsite Tunnelsite *Check one only*
- The name and address of the Locator is Merrill Palmer

	Name
<u>128 SUNRAY DR.</u>	<u>ARIZONA</u>
Address	State
<u>LAKE HAVASU CITY</u>	<u>86403</u>
City	Zip
- The name of the claim is Bouse # 9
- The date of the location is January 2, 2011
- The type of location monument is 2"x2"x5' wood Post
- The type of corner and end monument is 2"x2"x5' wood Post
- The claim is 1500 feet long and 600 feet wide. The Distance from the location monument to each end of the claim is 10 feet in a South direction and 1490 feet in a North direction.
- The general course is from the North to the South
- The location of the claim occupies all or part of the following quarter sections:

Quarter Section(s)	Section(s)	Township(s)	Range(s)
<u>NE 1/4</u>	<u>18</u>	<u>T 7 N</u>	<u>R 17 W</u>
<u>NW 1/4</u>	<u>17</u>	<u>T 7 N</u>	<u>R 17 W</u>
- The locality of this claim with reference to some natural object or permanent monument and additional information (if any) concerning its locality are as follows:
The NE corner of this claim is about 300 FT EAST from the common corners of Survey Monument of Sections 7, 8, 17, 18; T 7 N, R 17 W
- If amending, the previous claim name was _____ recorded in Docket _____, Book _____, Mining District _____, County, Arizona.

AMC 406767

Date January 2, 2011

Merrill Palmer
Signature

MAP OF MINING CLAIM LOCATION

- The name of the claim is Bouse # 9
- Type of claim is Placer Lode Millsite Tunnelsite *Check only one*
- The NE corner of the claim is about 300 feet in a west direction to a survey monument as described as CORNER FOR SECTIONS 7, 8, 18, 17 T7N R17W
- The bearing and distance between the corners of the claim are beginning at the NW corner of the claim, 600 feet in a EAST direction to the NE corner, then 1500 feet in a South direction to the SE corner, then 600 feet in a west direction to the SW corner, then 1500 feet in a North direction to the point of beginning.

MAP

One inch = Two thousand feet

North arrow

PHOENIX, ARIZONA

2011 MAR 22 10 21 AM

RECEIVED
BLM AZ STATE OFFICE

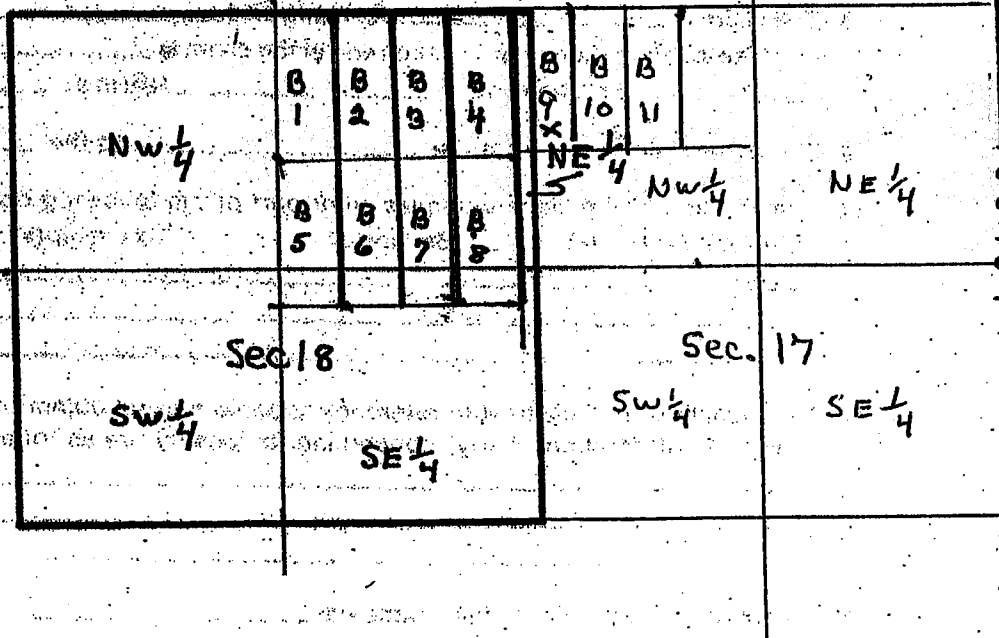

Section 18 Township T7N Range R17W G & SRB & M

Date January 2, 2011

Merrill Palmer
Signature

AMC 406187

Recorded at the Request of:

When recorded mail to:
Merrill Palmer
128 SUNRAY DR.
LAKE HAVASU CITY
86403

RECEIVED
BLM AZ STATE OFFICE
2011 MAR 24 A 9:39
PHOENIX, ARIZONA

NOTICE OF MINING CLAIM LOCATION

- Location Amendment Check one only
- Placer Lode Millsite Tunnelsite Check one only
- The name and address of the Locator is Merrill Palmer

	Name
<u>128 SUNRAY DR.</u>	<u>ARIZONA</u>
Address	State
<u>LAKE HAVASU CITY</u>	<u>86403</u>
City	Zip
- The name of the claim is Bouse # 10
- The date of the location is January 2, 2011
- The type of location monument is 2"x2"x5' wood Post
- The type of corner and end monument is 2"x2"x5' wood Post
- The claim is 1500 feet long and 600 feet wide. The Distance from the location monument to each end of the claim is 10 feet in a South direction and 1490 feet in a North direction.
- The general course is from the North to the South.
- The location of the claim occupies all or part of the following quarter sections:

Quarter Section(s)	Section(s)	Township(s)	Range(s)
<u>NW 1/4</u>	<u>17</u>	<u>T7N</u>	<u>R17W</u>
- The locality of this claim with reference to some natural object or permanent monument and additional information (if any) concerning its locality are as follows:
The NE CORNER of This Claim is About 900 FT EAST from The COMMON CORNER Survey Monument of SECTIONS 7, 8, 17, AND 18 T7N R17W
- If amending, the previous claim name was _____ recorded in Docket _____, Book _____ Mining District, _____ County, Arizona.

Date January 2, 2011

Merrill Palmer
Signature

AMC 406768

MAP OF MINING CLAIM LOCATION

- The name of the claim is Bouse # 10
- Type of claim is Placer Lode Millsite Tunnel site *Check only one*
- The NE corner of the claim is about 900 feet in a west direction to a survey monument ~~described as~~ described as CORNER For Sections 7, 8, 18, 17 T7N R17W
- The bearing and distance between the corners of the claim are beginning at the NW corner of the claim, 600 feet in a EAST direction to the NE corner, then 1500 feet in a South direction to the SE corner, then 600 feet in west direction to the SW corner, then 1500 feet in a North direction to the point of beginning.

MAP

One inch = Two thousand feet

North arrow

PHOENIX, ARIZONA

2011 MAR 29 10:30 AM

RECEIVED
MINAZ STATE OFFICE

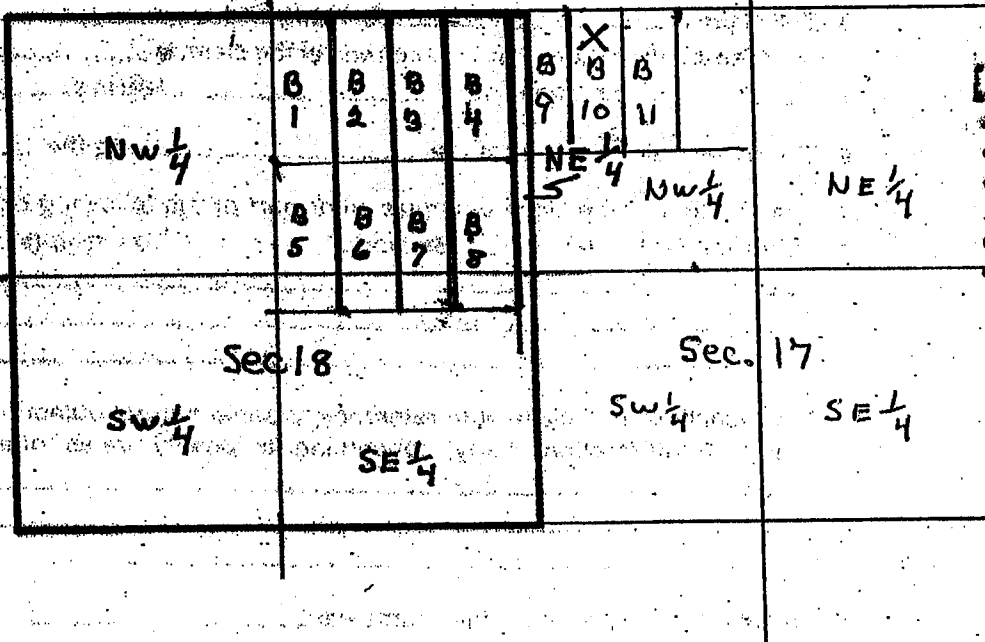

Section 18 Township T 7 N Range R 17 W G & SRB & M

Date January 2, 2011

Merrill Palmer
Signature

Recorded at the Request of:

When recorded mail to:

MERRILL PALMER
128 SUNRAY DR.
LAKE HAVASU CITY
86403

PHOENIX ARIZONA

2011 MAR 24 A 9:39

RECEIVED
LA PAZ STATE OFFICE

NOTICE OF MINING CLAIM LOCATION

1. Location Amendment Check one only
2. Placer Lode Millsite Tunnelsite Check one only
3. The name and address of the Locator is Merrill Palmer

	Name
<u>128 SUNRAY DR.</u>	<u>ARIZONA</u>
Address	State
<u>LAKE HAVASU CITY</u>	<u>86403</u>
City	Zip
4. The name of the claim is Bouse # 11
5. The date of the location is January 2, 2011
6. The type of location monument is 2"x2"x5' wood Post
7. The type of corner and end monument is 2"x2"x5' wood Post
8. The claim is 1500 feet long and 600 feet wide. The Distance from the location monument to each end of the claim is 10 feet in a South direction and 1490 feet in a North direction.
9. The general course is from the North to the South.
10. The location of the claim occupies all or part of the following quarter sections:

Quarter Section(s)	Section(s)	Township(s)	Range(s)
<u>NW 14</u>	<u>17</u>	<u>T7N</u>	<u>R17W</u>
_____	_____	_____	_____
_____	_____	_____	_____
11. The locality of this claim with reference to some natural object or permanent monument and additional information (if any) concerning its locality are as follows:
The NE corner of This Claim is about 1500 FT EAST from The Survey Monument for Sections 7, 8, 17 and 18, T7N, R17W
12. If amending, the previous claim name was _____ recorded in Docket _____, Book _____, Mining District _____, County, Arizona.

Date January 3, 2011

Merrill Palmer
Signature

AMC 406769

MAP OF MINING CLAIM LOCATION

- The name of the claim is Bouse # 11
- Type of claim is Placer Lode Millsite Tunnelsite *Check only one*
- The NE corner of the claim is about 1500 feet in a West direction to a survey monument described as CORNER For Sections 7, 8, 18, 17 T7N R17W
- The bearing and distance between the corners of the claim are beginning at the NW corner of the claim, 600 feet in a EAST direction to the NE QUARTER corner, then 1500 feet in a South direction to the SE corner, then 600 feet in a West direction to the SW corner, then 1500 feet in a North direction to the point of beginning.

MAP

One inch = Two thousand feet

North arrow

PHOENIX, ARIZONA

2011 MAR 21 A 9:39

RECEIVED
LMAZ STATE OFFICE

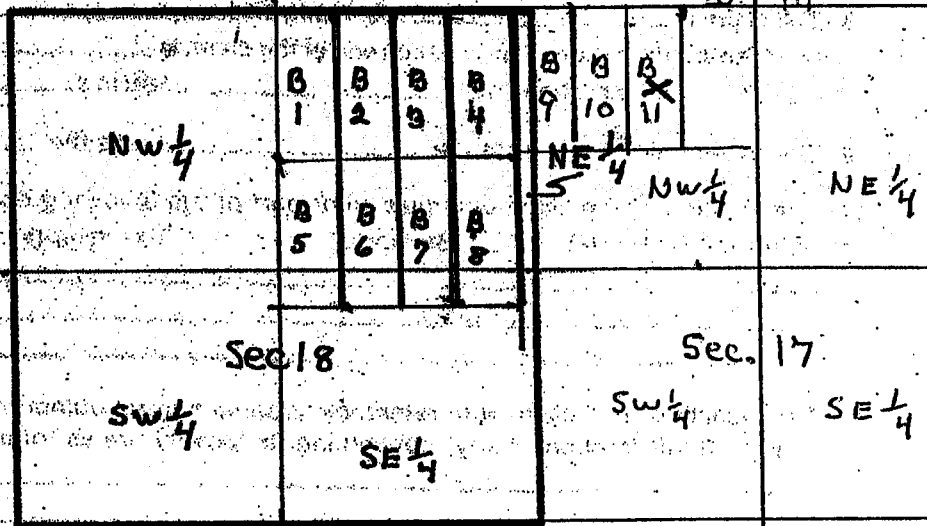

Section 18 Township T 7 N Range R 17 W G & SRB & M

Date January 2, 2011

Merrill Palmer
Signature

RUN TIME: 02:57 PM

UNITED STATES DEPARTMENT OF INTERIOR
BUREAU OF LAND MANAGEMENT
GEOGRAPHIC REPORT WITH LAND
Sorted by Meridian Township Range

RUN DATE: 03/31/2011
Page 1 of 6

Adm State: AZ

Serial Number: AZA 004732

Total Case Acres: 20.000

<u>Casetype</u>	<u>Case Disp</u>			<u>Sect</u>	<u>Sur Typ</u>	<u>Sur Num</u>	<u>Suff</u>	<u>Subdivision</u>	<u>Act Pend</u>
240006	AUTHORIZED	14	0070N	0170W	028	MNR	1	N2NENE;	

Serial Number: AZA 00473201

Total Case Acres: 20.000

<u>Casetype</u>	<u>Case Disp</u>			<u>Sect</u>	<u>Sur Typ</u>	<u>Sur Num</u>	<u>Suff</u>	<u>Subdivision</u>	<u>Act Pend</u>
291200	AUTHORIZED	14	0070N	0170W	028	MNR	1	N2NENE;	

Serial Number: AZA 006876

Total Case Acres: 0.196

<u>Casetype</u>	<u>Case Disp</u>			<u>Sect</u>	<u>Sur Typ</u>	<u>Sur Num</u>	<u>Suff</u>	<u>Subdivision</u>	<u>Act Pend</u>
286001	AUTHORIZED	14	0070N	0170W	019	ALIQ		NESE;	

Serial Number: AZA 018692

Total Case Acres: 1.500

<u>Casetype</u>	<u>Case Disp</u>			<u>Sect</u>	<u>Sur Typ</u>	<u>Sur Num</u>	<u>Suff</u>	<u>Subdivision</u>	<u>Act Pend</u>
281007	AUTHORIZED	14	0070N	0170W	035	FF	1	NORTH 33' OF NWNW;	
				036	FF		1	NORTH 33' OF W2NWNW;	

Serial Number: AZA 018945

Total Case Acres: 1.820

<u>Casetype</u>	<u>Case Disp</u>			<u>Sect</u>	<u>Sur Typ</u>	<u>Sur Num</u>	<u>Suff</u>	<u>Subdivision</u>	<u>Act Pend</u>
285003	AUTHORIZED	14	0070N	0170W	017	MNR		SESESE;	

RUN TIME: 02:57 PM

Adm State: AZ

UNITED STATES DEPARTMENT OF INTERIOR
BUREAU OF LAND MANAGEMENT
GEOGRAPHIC REPORT WITH LAND
Sorted by Meridian Township Range

RUN DATE: 03/31/2011
Page 2 of 6

020 ALIQ N2,N2S2;

Serial Number: AZA 022098PT

Total Case Acres: 33,995.040

<u>Casetype</u>	<u>Case Disp</u>	14	0070N	0170W	<u>Sect</u>	<u>Sur Typ</u>	<u>Sur Num</u>	<u>Suff</u>	<u>Subdivision</u>	<u>Act Pend</u>
221006	AUTHORIZED				002	ALIQ LOTS			S2N2,S2; 1-4;	

Serial Number: AZA 025926

Total Case Acres: 10.000

<u>Casetype</u>	<u>Case Disp</u>	14	0070N	0170W	<u>Sect</u>	<u>Sur Typ</u>	<u>Sur Num</u>	<u>Suff</u>	<u>Subdivision</u>	<u>Act Pend</u>
315100	AUTHORIZED				012	ALIQ			SE;	Y

Serial Number: AZA 027798

Total Case Acres: 81.499

<u>Casetype</u>	<u>Case Disp</u>	14	0070N	0170W	<u>Sect</u>	<u>Sur Typ</u>	<u>Sur Num</u>	<u>Suff</u>	<u>Subdivision</u>	<u>Act Pend</u>
240006	AUTHORIZED				036	ALIQ			SENE,NESE;	

Serial Number: AZA 02779801

Total Case Acres: 78.744

<u>Casetype</u>	<u>Case Disp</u>	14	0070N	0170W	<u>Sect</u>	<u>Sur Typ</u>	<u>Sur Num</u>	<u>Suff</u>	<u>Subdivision</u>	<u>Act Pend</u>
291200	AUTHORIZED				036	ALIQ			SENE,NESE;	

RUN TIME: 02:57 PM

Adm State: AZ

UNITED STATES DEPARTMENT OF INTERIOR
BUREAU OF LAND MANAGEMENT
GEOGRAPHIC REPORT WITH LAND
Sorted by Meridian Township Range

RUN DATE: 03/31/2011
Page 3 of 6

Serial Number: AZA 02779802

Total Case Acres: 78.744

<u>Casetype</u>	<u>Case Disp</u>	14	0070N	0170W	<u>Sect</u>	<u>Sur Typ</u>	<u>Sur Num</u>	<u>Suff</u>	<u>Subdivision</u>	<u>Act Pend</u>
274000	PENDING				036	ALIQ			SENE,NESE;	Y

Serial Number: AZA 027895

Total Case Acres: 80.000

<u>Casetype</u>	<u>Case Disp</u>	14	0070N	0170W	<u>Sect</u>	<u>Sur Typ</u>	<u>Sur Num</u>	<u>Suff</u>	<u>Subdivision</u>	<u>Act Pend</u>
240006	AUTHORIZED				022	ALIQ			SESW;	
					027	ALIQ			NENW;	

Serial Number: AZA 02789501

Total Case Acres: 80.000

<u>Casetype</u>	<u>Case Disp</u>	14	0070N	0170W	<u>Sect</u>	<u>Sur Typ</u>	<u>Sur Num</u>	<u>Suff</u>	<u>Subdivision</u>	<u>Act Pend</u>
291200	AUTHORIZED				022	ALIQ			SESW;	
					027	ALIQ			NENW;	

Serial Number: AZA 02789502

Total Case Acres: 80.000

<u>Casetype</u>	<u>Case Disp</u>	14	0070N	0170W	<u>Sect</u>	<u>Sur Typ</u>	<u>Sur Num</u>	<u>Suff</u>	<u>Subdivision</u>	<u>Act Pend</u>
274000	PENDING				022	ALIQ			SESW;	Y
					027	ALIQ			NENW;	Y

RUN TIME: 02:58 PM

UNITED STATES DEPARTMENT OF INTERIOR
BUREAU OF LAND MANAGEMENT
GEOGRAPHIC REPORT WITH LAND
Sorted by Meridian Township Range

RUN DATE: 03/31/2011
Page 4 of 6

Adm State: AZ

Serial Number: AZA 031074

Total Case Acres: 81.580

<u>Casetype</u>	<u>Case Disp</u>	14	0070N	0170W	<u>Sect</u>	<u>Sur Typ</u>	<u>Sur Num</u>	<u>Suff</u>	<u>Subdivision</u>	<u>Act Pend</u>
286203	AUTHORIZED				704	ALIQ			SWSW;	
					705	ALIQ			S2NW,S2;	
						LOTS			4;	
					706	LOTS			1,2;	
					723	ALIQ			E2SE;	
					725	ALIQ			SWSW;	
					726	ALIQ			NWNE;	
					736	ALIQ			SWNE,E2NW,SE;	

Serial Number: AZA 032444

Total Case Acres: 59,100.000

<u>Casetype</u>	<u>Case Disp</u>	14	0070N	0170W	<u>Sect</u>	<u>Sur Typ</u>	<u>Sur Num</u>	<u>Suff</u>	<u>Subdivision</u>	<u>Act Pend</u>
850010	AUTHORIZED				001	FF			PART;	
					002	FF			PART;	
					003	ALIQ			S2N2,S2;	
						LOTS			1-4;	
					004	FF			PART;	
					005	FF			PART;	
					006	FF			PART;	
					009	ALIQ			N2NE;	

Serial Number: AZA 033154

Total Case Acres: 0.050

<u>Casetype</u>	<u>Case Disp</u>	14	0070N	0170W	<u>Sect</u>	<u>Sur Typ</u>	<u>Sur Num</u>	<u>Suff</u>	<u>Subdivision</u>	<u>Act Pend</u>
380913	AUTHORIZED				018	MNR			E2NENW;	

RUN TIME: 02:58 PM

UNITED STATES DEPARTMENT OF INTERIOR
BUREAU OF LAND MANAGEMENT
GEOGRAPHIC REPORT WITH LAND
Sorted by Meridian Township Range

RUN DATE: 03/31/2011

Page 5 of 6

Adm State: AZ

Serial Number: AZA 034760

Total Case Acres: 80.000

<u>Casetype</u>	<u>Case Disp</u>	14	0070N	0170W	<u>Sect</u>	<u>Sur Typ</u>	<u>Sur Num</u>	<u>Suff</u>	<u>Subdivision</u>	<u>Act Pend</u>
311111	PENDING				024	ALIQ			W2SE;	Y

Serial Number: AZA 035339

Total Case Acres: 98.290

<u>Casetype</u>	<u>Case Disp</u>	14	0070N	0170W	<u>Sect</u>	<u>Sur Typ</u>	<u>Sur Num</u>	<u>Suff</u>	<u>Subdivision</u>	<u>Act Pend</u>
285003	AUTHORIZED				004	ALIQ			SWSW;	
					005	ALIQ			N2SE,S2SE;	
						LOTS			4;	
					006	ALIQ			SENE;	
						LOTS			1,2;	
					025	ALIQ			SWSW;	
					026	ALIQ			N2NE;	
					036	ALIQ			N2SE,SESE;	
						ALIQ			SWNE,NWNW,NENW,SENW;	

Serial Number: AZPHX 0009046

Total Case Acres: 193.964

<u>Casetype</u>	<u>Case Disp</u>	14	0070N	0170W	<u>Sect</u>	<u>Sur Typ</u>	<u>Sur Num</u>	<u>Suff</u>	<u>Subdivision</u>	<u>Act Pend</u>
284200	AUTHORIZED				004	ALIQ			SWSW;	
					005	ALIQ			S2NW,NESW,SE;	
						LOTS			3,4;	
					006	ALIQ			S2NE;	
						LOTS			1,2;	
					009	ALIQ			NW,SWNE,SE;	
					010	MNR		1	SWSWSW;	
					015	ALIQ			NW,SE;	
						MNR		1	NENESW;	
					022	ALIQ			E2NE;	
					023	ALIQ			W2;	
					025	ALIQ			SWSW;	

RUN TIME: 02:58 PM

Adm State: AZ

UNITED STATES DEPARTMENT OF INTERIOR
BUREAU OF LAND MANAGEMENT
GEOGRAPHIC REPORT WITH LAND
Sorted by Meridian Township Range

RUN DATE: 03/31/2011
Page 6 of 6

026 ALIQ E2,NENW;
036 ALIQ SWNE,NW,SE;

Serial Number: AZPHX 0009356

Total Case Acres: 19.966

<u>Casetype</u>	<u>Case Disp</u>	14	0070N	0170W	<u>Sect</u>	<u>Sur Typ</u>	<u>Sur Num</u>	<u>Suff</u>	<u>Subdivision</u>	<u>Act Pend</u>
284200	AUTHORIZED				022	ALIQ			NESE;	
					023	ALIQ			S2NW,SW;	

Serial Number: AZPHX 0079054

Total Case Acres: 475.210

<u>Casetype</u>	<u>Case Disp</u>	14	0070N	0170W	<u>Sect</u>	<u>Sur Typ</u>	<u>Sur Num</u>	<u>Suff</u>	<u>Subdivision</u>	<u>Act Pend</u>
282105	AUTHORIZED				025	ALIQ			SWSW;	
					026	ALIQ			N2NE;	
					036	ALIQ			N2,SE;	

MERRILL PALMER
128 SUNRAY DR.
LAKE HAVASU CITY, AZ.
86403



1006



85004

U.S. POSTAGE
PAID
PARKER, AZ
85344
MAR 22, 11
AMOUNT
\$5.80
00027582-03

United States Postal Service®
DELIVERY CONFIRMATION™



0310 0480 0001 0998 7581

To Dept. of The Interior U.S.
BLM ARIZONA STATE OFFICE
ONE NORTH CENTRAL AVE.
SUITE 800
PHOENIX, AZ.
85004-4427



Visit us at usps.com

Label 106A, May 2008



This product is for use with Priority Mail® shipments. Misuse may be a violation of federal law. This tape is not for resale.



Visit us at usps.com

Label 106A, May 2008



This product is for use with Priority Mail® shipments. Misuse may be a violation of federal law. This tape is not for resale.



Visit us at usps.com

Label 106A, May 2008



This product is for use with Priority Mail® shipments. Misuse may be a violation of federal law. This tape is not for resale.



Visit us at usps.com

Label 106A, May 2008

This product is for use with Priority Mail® shipments. Misuse may be a violation of federal law. This tape is not for resale.



Visit us at usps.com

Label 106A, May 2008

PRIORITY®
UNITED STATES POSTAL SERVICE



Visit us at usps.com

Label 106A, May 2008

This product is for use with Priority Mail® shipments. Misuse may be a violation of federal law. This tape is not for resale.



Visit us at usps.com

Label 106A, May 2008